



Feature :

- Failure detection/protection design
- Waterproof: IP69K on switch surface and inner structure
- LED indicator available
- Customize symbol available
- Panel mount design

Application :

- Automotive
- Start engine button



SWITCH SPECIFICATIONS	
POLE - POSITION	OFF - <ON> for Momentary Type , DPST
CONTACT RATING	0.2A 12V DC
CONTACT RESISTANCE	200Ω MAX.
INSULATION RESISTANCE	100 MΩ min. 100 V DC
DIELECTRIC STRENGTH	Breakdown is not Allowable ; 250 V AC for 1 Minute
OPERATING FORCE	300 ± 80 gf
OPERATING LIFE	500,000 cycles
OPERATING TEMPERATURE RANGE	-40°C ~ 85°C
TOTAL TRAVEL	1.8 ± 0.3 mm

LED SPECIFICATIONS								
ATTENTION LEDs are Electrostatic Sensitive devices 	Unit	Value / LED Color						
		Blue 5mA	Pure Green	Red	Yellow	Orange	Green	White
LUMINOUS INTENSITY@20mA I _v	mcd	40	200	280	80	280	30	150
Dominant Wavelength λ _D	nm	470	525	630	590	630	568	/
FORWARD VOLTAGE@20mA V _f	V	3.3	3.3	1.95	2	1.95	2.2	2.2

■ A single bin cannot be ordered, please contact us in advance if you need a particular bin sorting before placing your order to clarify the lead time, MOQ and pricing

▶ HOW TO ORDER

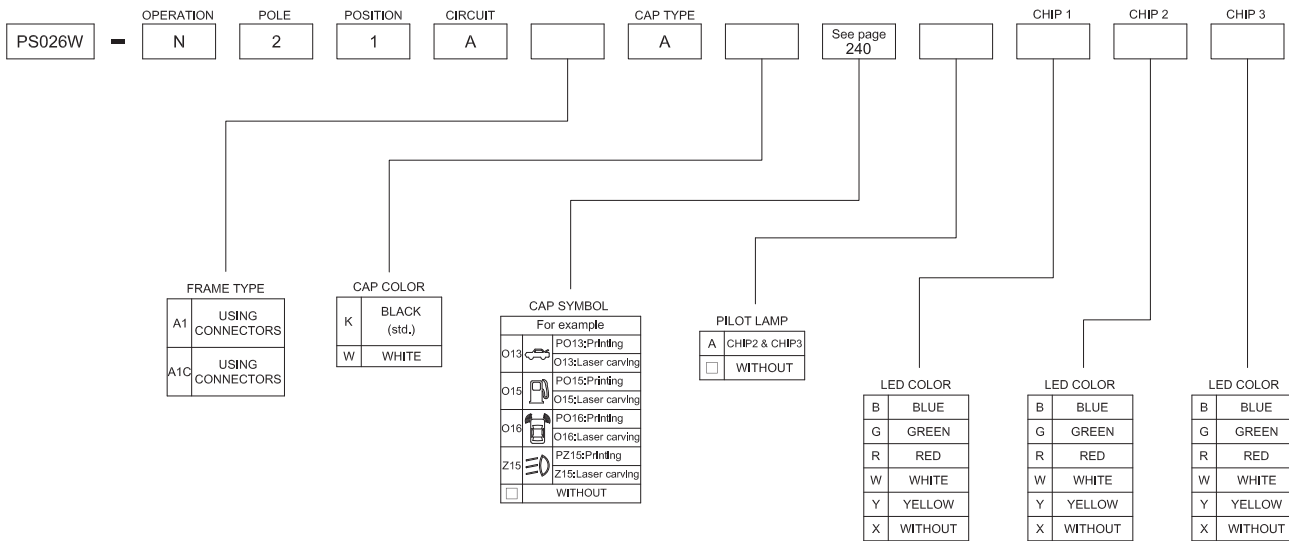

PS026W-N21AA1AKI23AYGR

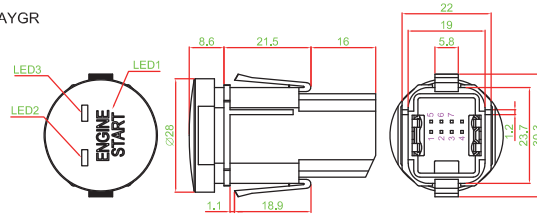

▶ CIRCUIT

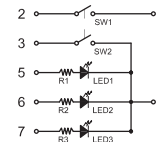

▶ PANEL CUT OUT

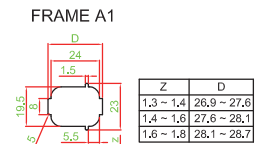

PS026W-N21AA1CAKI23YGR

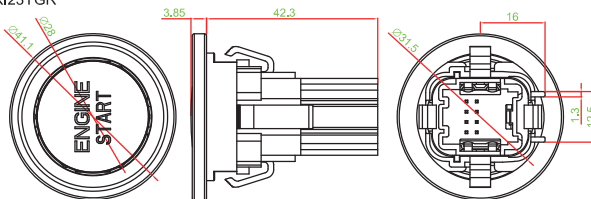

FRAME A1C

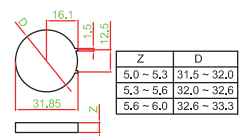

- TACT SWITCH
- PUSH BUTTON SWITCH
- LED TOUCH SENSOR SWITCH
- 5 DIRECTION NAVIGATION SWITCH WITH LED
- MEMBRANE SWITCH
- LED LIGHT BAR
- SLIDE SWITCH
- ROTARY SWITCH
- ROCKER SWITCH
- DETECT SWITCH
- ENCODER
- INTERRUPTER
- MINIATURE MICRO SWITCH
- TELEPHONE HOOK SWITCH
- DOOR SWITCH
- MINI SIZE SOCKET
- KNOB
- CAP SYMBOL